



Satellite Radio & GPS Active Repeater



Features

- ✓ Selectable gain
- ✓ Versatile operation
- ✓ Universal construction
- ✓ Compact size 3.9" dia. x 1.5" height
- ✓ Indoor re-radiation of Satellite Radio & GPS signals

As many people have experienced with wireless systems, there are many areas where coverage is weak such as in residential homes, apartment buildings, office buildings, and shopping malls. This is true even for GPS and Satellite Radio systems.

QualSense's new Satellite Radio and GPS Repeaters with selectable gain eliminate these weak coverage areas in one compact and lightweight unit.

The repeaters can be configured to provide Satellite Radio, GPS, or any similar one-directional RF signal coverage. With the new selectable gain, these repeaters provide quality operation indoors over the required distance.

The versatile operation of the repeaters allows the units to be used with any type of system modulation/coding within the specified bandwidth/frequency.

QualSense's repeaters will keep you covered.

Specifications	Satellite Radio	GPS
Frequency Band	2320-2345 MHz +/- 10Mhz	1575 MHz +/-5MHz
Gain (Center Frequency) Selectable Range GL/GH Switch	-3-15 db typical 15-30 db Typical	0-20 db typical 20-40 db typical
Gain Flatness (full band)	± 0.6 db	± 0.5db
Noise Figure	3.7 db	3.2 db
Input Impedance	50 ohms	50 ohms
Input VSWR	1.5	1.4
Time Delay	< 0.12 nsec	< 0.14 nsec
Out IP1 (db)	16 dbm	16 dbm
Out IP3 (db)	25 dbm	25 dbm
Supply Voltage Regulated	5 V, 12 V ± 5%	5V,12 V ± 5%
Protections	Current overload Current short circuit Voltage overload Reverse polarity protection ESD- 8KV	Current overload Short circuit Voltage overload Reverse polarity protection ESD-8KV
Supply Current	< 150 ma	< 150 ma
On-Board Indoor Antenna	Ceramic Patch	Ceramic Patch
Antenna Impedance	50 Ohms	50 Ohms
Antenna Gain	0.5 dbi	2.6 dbi
Operating Temp	0-65 C	0-65C
Input RF Connector	* SMB/ SMA	*SMB/SMA
Connector Voltage to Outdoor Antenna	5V ± 0.3V	5V ± 0.3V
Power "ON"	Green	Green
Dimensions	3.9" Diameter, 1.5" Thick	3.9" Diameter, 1.5" Thick
Weight	< 7 oz.	< 7oz.
Hardware	Mounting Bracket	Mounting Bracket

Note: Specifications subject to change without notice.

QualSense Affiliated Partner



MECHANICAL DRAWING

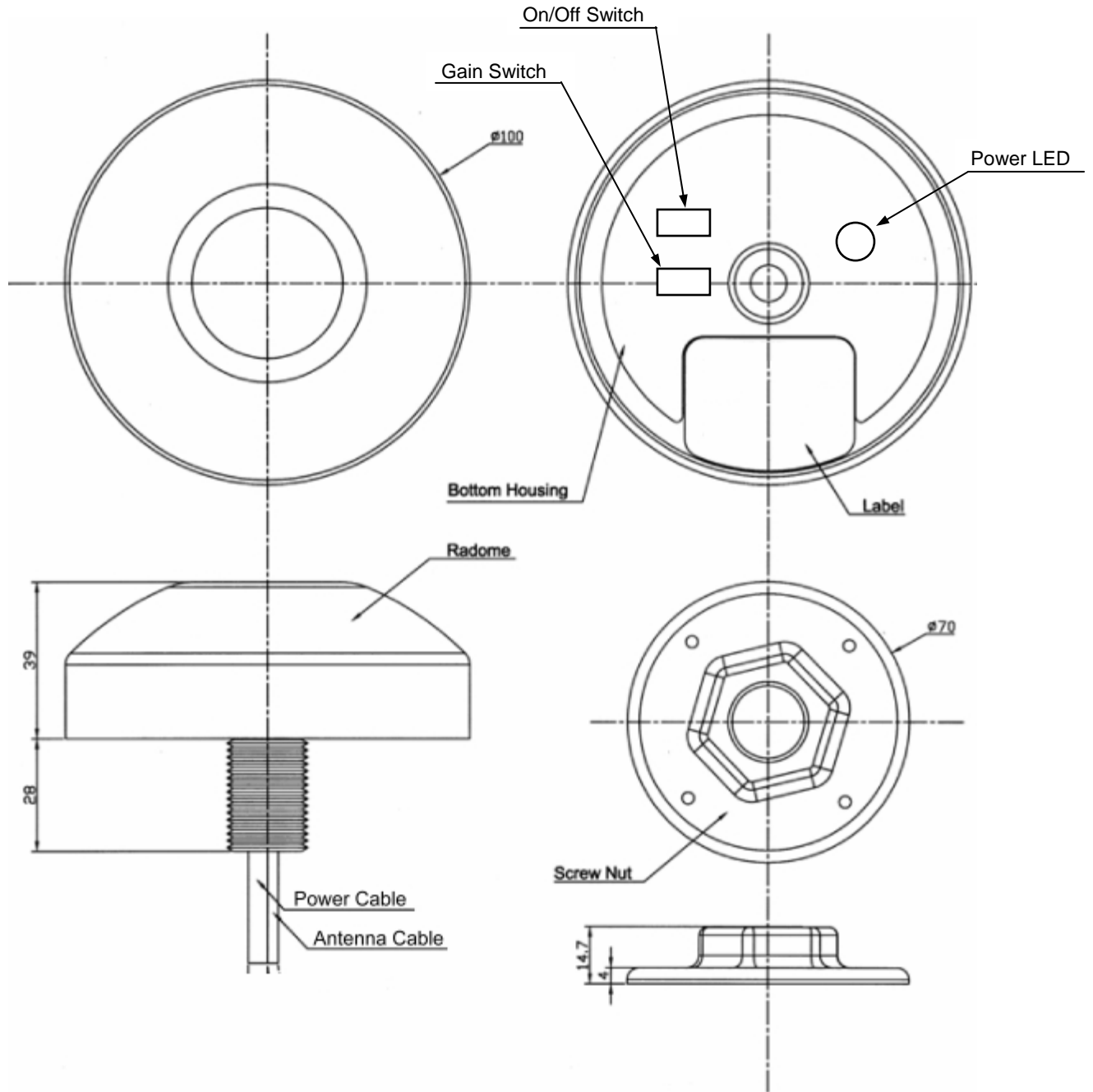

Housing Material: PC
Unit: mm